

LUXURY
Yacht
GROUP
PRESENTS FOR SALE



SOLEMATES

A Truly Exceptional Yacht for a Highly Discerning Owner



118' LENGTH



6.5' DRAFT



10 GUESTS



5 CABINS



6 CREW

SPECIFICATIONS

BUILDER: Mulder Shipyard (The Netherlands)

BUILT/DELIVERED: 2022 (July)

NAVAL DESIGN: Van Oossanen Naval Architects

HULL: Fast Displacement, Aluminum

LENGTH OVERALL: 118.1 ft / 36 m

LENGTH WATERLINE: 109.6 ft / 33.41 m

BEAM: 26.2 ft / 8 m

DRAFT: 6.5 ft / 1.98 m (light ship)

DISPLACEMENT: Approx. 218 tons

ENGINES: (2) 1150 hp Caterpillar C18 2300 RPM

CRUISING SPEED: 12 knots (max. 17 knots)

RANGE: 2,200 nautical miles (transatlantic)

STABILIZERS: Zero Speed Fins & Gyro Stabilizers

GROSS TONS: 296 GT

FLAG: Cayman Islands (REG Yacht Code)

VAT STATUS: VAT not paid; exported outside EU

CLASS: ABS A1, Commercial Yachting Service,
E, AMS (#YY281780)

LYING: Fort Lauderdale, FL, USA

FEATURES

Spacious full-beam master suite with signature skylights on main deck

Fold-out balcony with manual-place railings

Interior and exterior dining tables for 10

Large circular jacuzzi with surrounding bar seating on sun deck with panoramic views

Flybridge wet bar with fridge, grill, and hot/cold sink

Williams Dieseljet 6.25m tender in special cross sectional 'garage' with hull door

SALES PRICE

€22,000,000

(Not for sale to US owners in US waters)

EXCLUSIVE SALES CONTACT

Rupert Connor

rc@luxyachts.com

+1 954 205 0070

luxyachts.com

LUXURY *Yacht* GROUP

SOLEMATES

The 118 ft motor yacht Solemates was built by Mulder Shipyard in 2022. Constructed on a fast displacement aluminum hull with a 26.2 ft beam, she offers a sleek silhouette and spacious accommodations across two decks, with a total volume of 296 GT.

Exterior

Her elegant lines and straight bow enhance both performance and interior volume. The expansive "two-and-a-half deck" design maximizes exterior space for relaxation and entertaining. Guests can enjoy the spacious main aft deck and luxurious sun deck with a spa pool, bar, and retractable TV. The beach club, garage with Williams 625 tender, and large swim platform make enjoying water activities a breeze.

Interior

Solemates' interior combines a rich blend of oak and teak. The open-plan main deck integrates living and dining areas, complete with a sit-at bar and balcony for alfresco dining. Advanced technology, including iPad-controlled entertainment and ambient settings, confirms modern luxury throughout.

Accommodation

Accommodating 10 guests in 5 luxurious cabins, including a main-deck owner's suite, Solemates is designed for comfort and privacy. The flexible guest cabins and well-appointed crew quarters ensure the highest standards of service.

Performance

Powered by twin Caterpillar C18 engines, Solemates cruises comfortably at 12 knots, reaching a top speed of 17 knots. Her impressive range and robust design allow for extended transatlantic voyages and unrestricted navigation while meeting the highest safety standards.



LUXURY
Yacht
GROUP



LUXURY
Yacht
GROUP





LUXURY
Yacht
GROUP



LUXURY
Yacht
GROUP





LUXURY
Yacht
GROUP

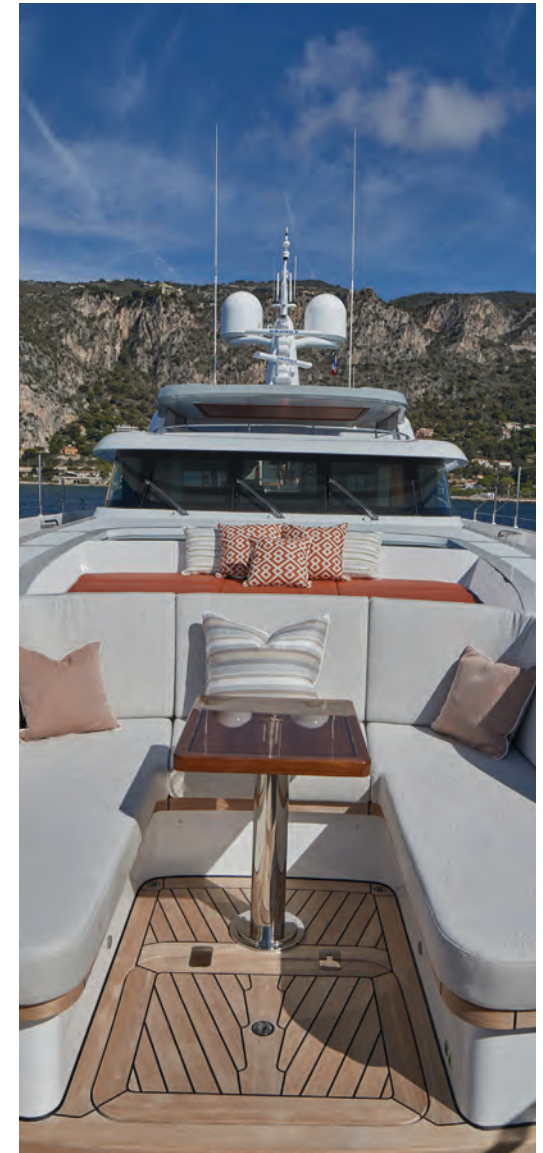

LUXURY
Yacht
GROUP



LUXURY
Yacht
 GROUP
 LAYOUT

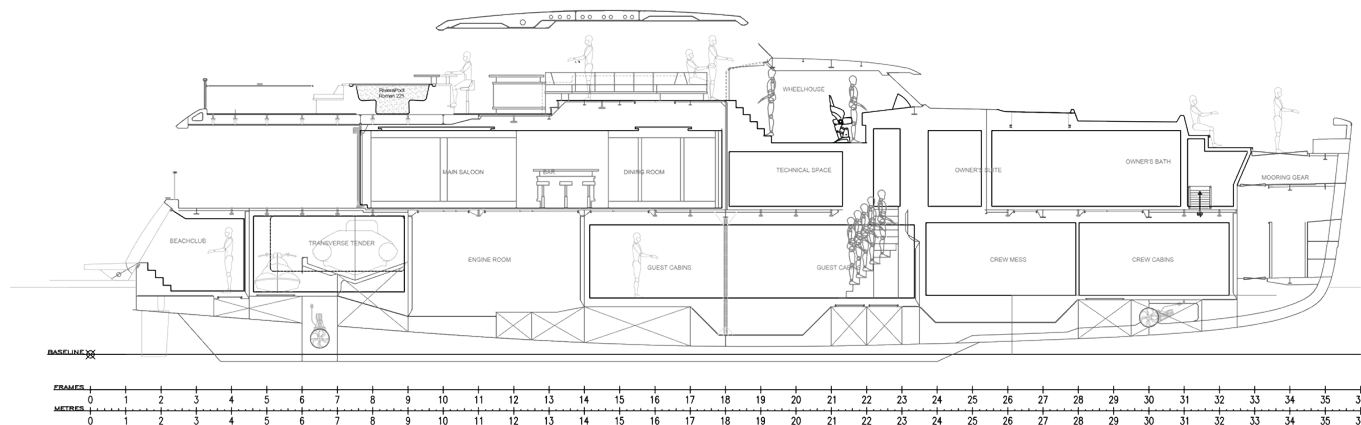
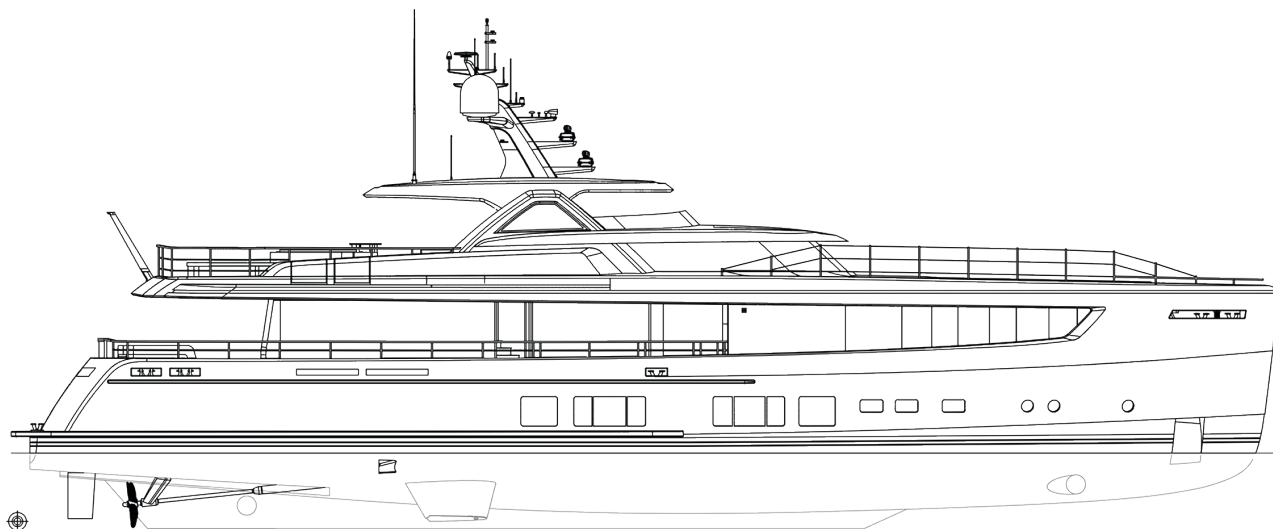

LONGITUDINAL
 SECTION

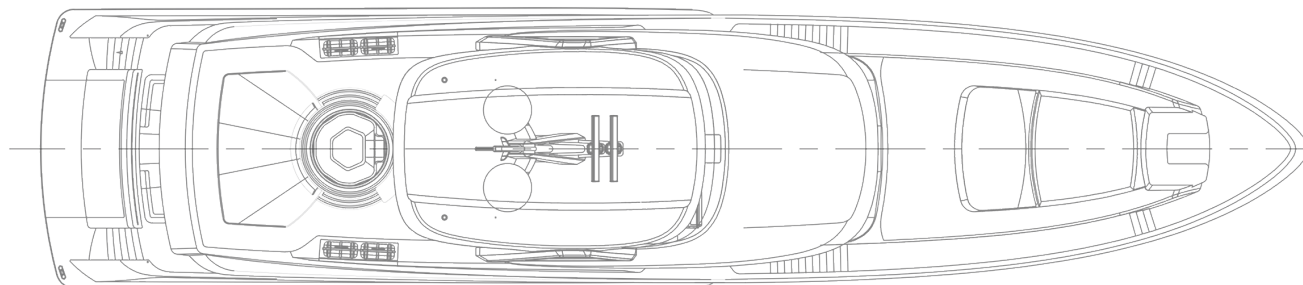

BIMINI

LUXURY
Yacht
 GROUP
 LAYOUT

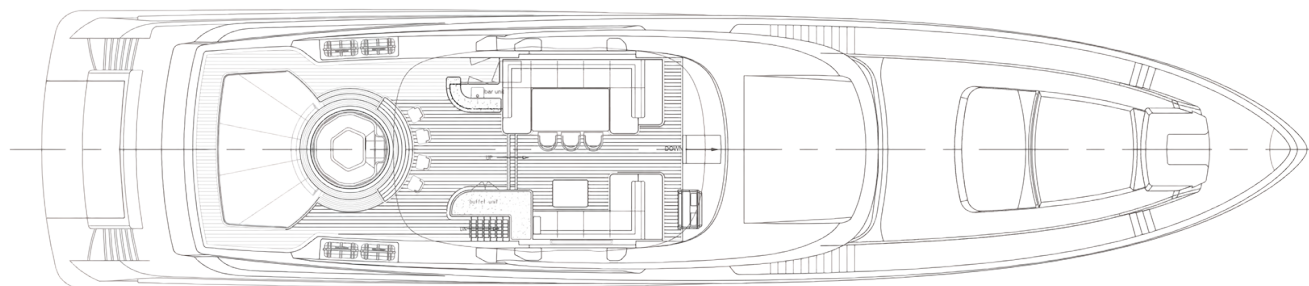

SUNDECK

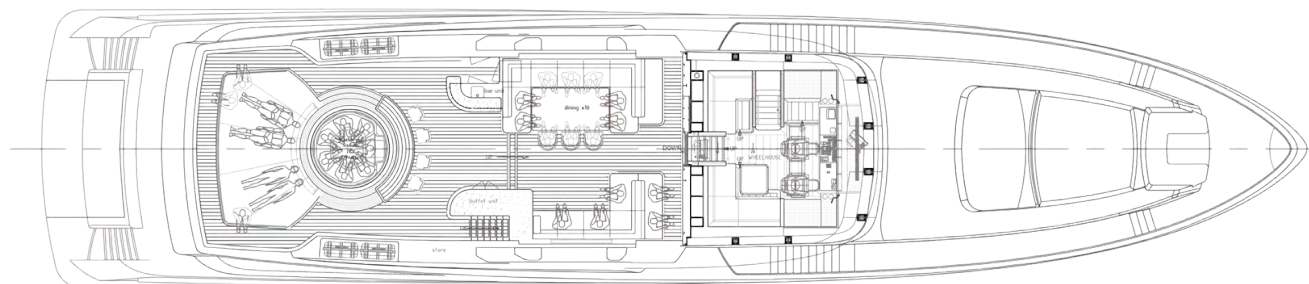

WHEELHOUSE

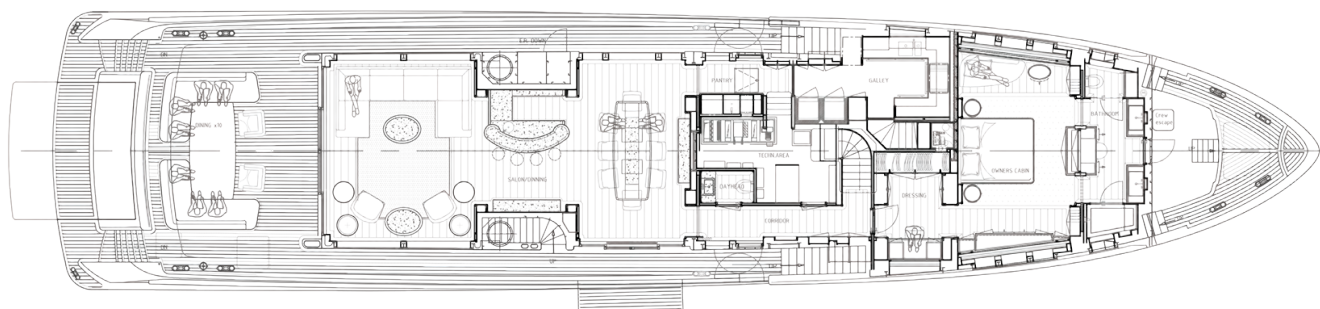

MAIN DECK

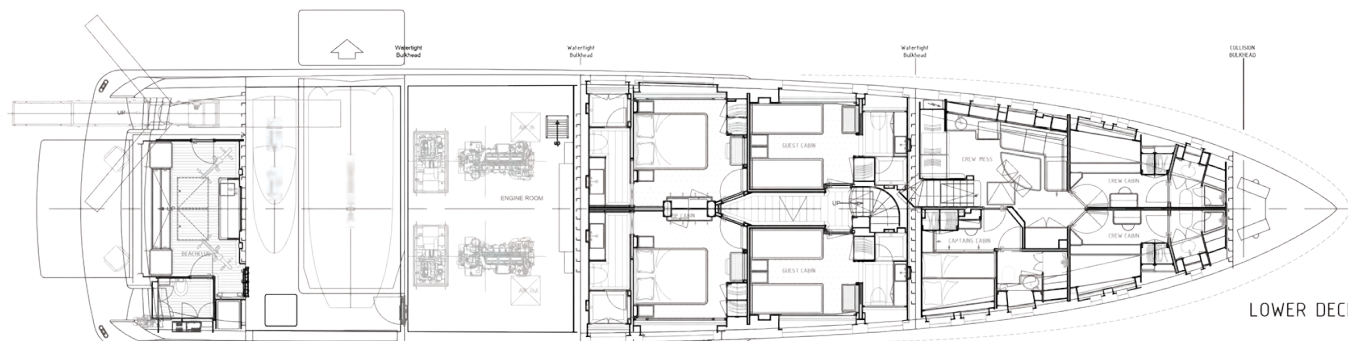

LOWER DECK

GENERAL SPECIFICATIONS

TYPE	Motor Yacht
YEAR BUILT	2022
BUILDER	Mulder Shipyard
HULL	Hull #5
FLAG	Cayman Islands REG Yacht Code
DIMENSIONS	Length Overall: 36 m (118.1 ft) Length Waterline: 33.41 m (109.6 ft) Beam: 8 m (26.2 ft) Draft at SLL: ±1.98 m (6.5 ft) Depth Moulded: ±3.83 m (12.6 ft)
TONNAGE	Gross: ±296 GT Displacement: ±218 tons (Summer Load Line)
NAVAL ARCHITECT	Van Oossanen Naval Architects
INTERIOR DESIGNER	Vickers Studio & Mulder Shipyard
EXTERIOR STYLING	Mulder Shipyard
CONSTRUCTION	Hull & Superstructure: Aluminum
VESSEL TYPE	Round-bilged, fast displacement hull with watertight bulkheads
CLASSIFICATION	ABS A1 Yachting, Commercial Yachting Service, AMS

MACHINERY

MAIN ENGINES	(2) Caterpillar C18SWAC ACERT 847bKW @ 2300 RPM With remote and local control 24V starting system
ENGINE HOURS (Oct 2024)	Port: 1926 hours Starboard: 1924 hours
PROPULSION	Twin propulsion connected to reduction gearboxes, straight drive, water lubricated stainless steel shafts driving fixed pitch propellers
GEAR BOXES	ZF, reduction ratio 4:1 with PTO & 130 cc hydraulic pumps
SHAFTS	Water lubricated system
PROPELLERS	Nibral bronze 5 bladed, type Skew Back, 1.350mm dia.
SPEEDS	Cruising Speed: 12 Knots Top Speed: 17 Knots
FUEL CONSUMPTION	160L/hour at 12-13 knots
RANGE	±3,400 Nm (transatlantic, unrestricted)

TANK CAPACITIES

FUEL	±28,600 L
FRESH WATER	±5,700 L
GREY WATER	±2,600 L
BLACK WATER	±1,800 L
DIRTY OIL	±600 L
SLUDGE TANK	±500 L

AUXILIARY MACHINERY & ELECTRICAL SYSTEM

MAIN GENERATORS	(2) Zenoro John Deere generators 80 kWe output, 50Hz, 1500RPM
GENERATOR HOURS (Oct 2024)	Port: 4715 hours Starboard: 4182 hours
ELECTRICITY	European frequency parallel system, system voltage 230/400V-50 Hz with 80 kVA shore power converter
SHORE POWER CONVERTER	MarPower SPC-II Hybrid 80kW/100kVA at the aft ship
HARMONIC FILTER	Hyteps AHF 60A
BATTERIES	Battery set of 530Ah consisting of: (4) Victron Deep Cycle Gel 265Ah (2) Battery charger Victron Skylla 24/50 TG (1) Earth fault measurement / alarm (1) Ampere measurement / alarm (1) Volt measurement / alarm

COMMUNICATION EQUIPMENT

INTERNET	Starlink
JOTRON	Tron TR30 x 2
VHF RADIO	FURUNO
TELEPHONE	Panasonic
INMERSAT-C	FURUNO Felcom-18

ANCILLARY EQUIPMENT

STEERING SYSTEM	Hydraulic cylinder between twin spade rudders
RUDDER ANGLE INDICATORS	In wheelhouse and flybridge
BOW & STERN THRUSTERS	Hydraulic 85 HP - Side Power Type SH 1000/513 TC
STABILIZERS	CMC CC Jensen
FUEL FILTERS SEPARATOR	Gianneschi
BILGE PUMP	Gianneschi
FIRE PUMP	Emergency diesel fire pump
BOILERS	(2) 240 Liter 3kw 400-volt tanks
WATER MAKER	(2) HEM 25/1600 250 liters per hour
SEWAGE TREATMENT	Hamann
TOILETS	Planus for marine with pre- and flush touch panel Dayhead toilet powered by battery in case of black-out
AIR CONDITIONING	Marine Air MCW Modular Chiller
VENTILATION	Marine Air system, type AT24HVZ-2.5 Kw-MU
COMFORT CONTROLS	iPad Minis throughout control lighting, blinds, and HVAC

SAFETY & SECURITY EQUIPMENT

SAFETY	(4) 8-person self-inflating life rafts
FIRE FIGHTING	Eltek fire detection system connected to monitoring Hand carried fire extinguishers in all guest cabins
ALARMS & MONITORING	Böning M&C network system running HMI software spread throughout yacht and connected via dedicated LAN
SECURITY	4 x IP fixed cameras in engine room 2 IP outdoor camera in the walk-a-ways 1 IP outdoor fixed camera forward on the mast 2 IP outdoor fixed cameras on the Bow (forward and down)

NAVIGATION EQUIPMENT

CONTROL STATIONS	Two fixed positions, one in wheelhouse, one on flybridge and one extra remote control. Wireless remote control which operates the gearboxes, bow thruster, and stern thruster
BRIDGE STATION	SCHLEGEL, QUATRON-JUWEL series IP65
AUTOMATIC PILOT	Simrad AP-70
LOG	FURUNO
ECHO SOUNDER	Airmar DST800
RADARS	FURUNO
CHART PLOTTER	FURUNO
GPS	FURUNO
WIND INSTRUMENTS	FURUNO
AIS	Furuno FA-170
MAST	Intellian Vsat V80

DECK EQUIPMENT

ANCHORS	(2) 167kg SHHP Pool
WINDLASS	Maxwell type 6000 VWC with Capstan, hydraulic
CHAINS	2 x galvanized U-2 (stud link) chains, 200m length
MAIN DECK BALCONY	Hydraulic hinged balcony on main deck starboard, with teak floor and manual stainless steel fences
BOAT CRANE & DAVITS	Emergency davit (manual)
PASSERELLE	Hydromar hydraulic telescopic passerelle
SWIMMING PLATFORM	Teak, with port and starboard stairs to aft deck & shower
AWNINGS	Fabric sun awnings supported by carbon fiber poles
DECK MATERIAL	Best grade sawn Burma teak, 12 mm finished thickness

ACCOMMODATION

Accommodation for 10 guests in 5 cabins	
OWNER	(1) Owner cabin
GUESTS	(2) Double cabins + (2) Double/twin cabins
CREW	(3) Crew cabins for (6) crew members

FINISHES

WOOD FINISH	Open grain teak, matt varnished finish
WOODEN FLOORING	Oak planking in salon, wheelhouse, pantry, dining, lobby
HANDRAILS	In all owner's and guest areas, stair handrails with stainless steel leather grips
ARTWORK & PERSONAL EFFECTS	Owner's artwork, décor and personal effects reserved

AUDIO/VISUAL ENTERTAINMENT SYSTEMS

THROUGHOUT VESSEL Qled Samsung TVs

Apple iPad mini

Apple TV 4K

Nexgentec BTI AES67 Bluetooth® Interface

Bowers & Wilkens CCM-362 in-ceiling speakers

Satellite receivers Vu+ UNO 4K SE UHD TV DVB-S2 FBC

HDMI wall inputs

TENDER & WATERSPORTS EQUIPMENT

TENDER

2020 Williams Dieseljet 625 rigid inflatable, 300 hours
(as of 10/2024), HIN: GB-WMRD4077D020,
marked "T/T SOLEMATES"

WATERSPORTS

2022 SeaDoo personal watercraft, 24.7 hours
(as of 10/2024), HIN: CA-YDVA8816E222,
marked "T/T SOLEMATES"

2022 SeaDoo personal watercraft, 25.3 hours
(as of 10/2024), HIN: CA-YDV39296L122,
marked "T/T SOLEMATES"

DOMESTIC EQUIPMENT

MAIN GALLEY

An induction hob with 5 burners, equipment: sea rail fittings

(1) Extractor fan

(1) Built-in steam oven

(1) Built-in microwave

+ 1 in crew mess

(1) Miele commercial dish washer with short cycle

(2) Hot water machines (Quooker) (pantry + galley)

(1) Icemaker (pantry)

(1) Miele commercial dish washer
for glasses (pantry + 1 non-commercial in crew)

(1) Wine cooler (bar)

(2) 520-liter fridges (custom build, Frigomar)

GALLEY CREW

Extra freezer and cool capacity underneath the galley floor,
1 fridge, 1 microwave, 1 sink



DISCOVER LUXURY

LUXURY *Yacht* GROUP

Luxury Yacht Group LLC

Sales • Charter • Management • Crew

+1 954 525 9959

www.luxyachts.com

101 SE 14th Street, Fort Lauderdale, FL 33316, USA

USA • Spain • France • New Zealand

Disclaimer

This is provided for informational purposes only and is not intended to be a binding offer or contract. All details are presented in good faith, but Luxury Yacht Group LLC makes no warranties or representations regarding the accuracy, completeness, or usefulness of the information and images contained herein. Yacht inventory, availability, specifications, features, locations, crew, charter prices and other details are subject to change without notice. Reproduction of any text or images found herein is prohibited without written consent from Luxury Yacht Group LLC. © Luxury Yacht Group 2024.